

HYUNDAI
POWER PRODUCTS

**ELECTRIC WEED BURNER
HWE2000**

ORIGINAL INSTRUCTIONS

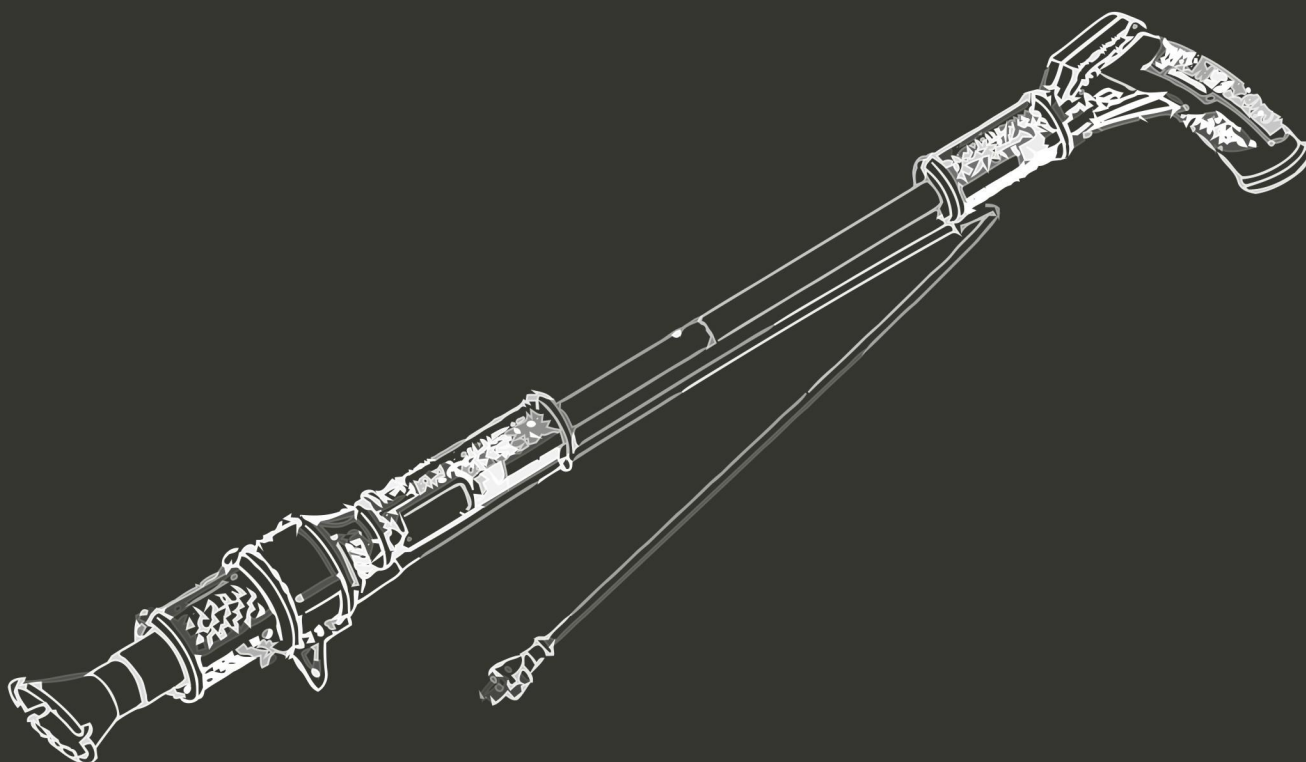

WARNING: Read thoroughly the instruction manual before use !

CONTENTS

1. INTENDED USE	3
2. SAFETY INSTRUCTIONS	3
3. THE PRODUCT	10
4. ASSEMBLY	11
5. OPERATION	11
6. CLEANING AND MAINTENANCE	12
7. DISPOSAL	12
8. DECLARATION OF CONFORMITY	13
9. WARRANTY	14
10. PRODUCT FAILURE	15
11. WARRANTY EXCLUSIONS	16

1. INTENDED USE

This electric weed burner works without making use of chemical pesticides, gas or open flame.

The device can also be used to quickly and safely light a barbecue.

Not suitable for professional use.

WARNING! Read this manual and general safety instructions carefully before using the appliance, for your own safety. Your power tool should only be passed on together with these instructions.

2. SAFETY INSTRUCTIONS

2.1 GENERAL SAFETY WARNINGS

Read all safety warnings and instructions. Failure to heed warnings and follow instructions may result in electric shock, fire and/or serious injury. Keep safety warnings and instructions for future reference.

This appliance can be used by children aged from 8 years and above and persons with reduced physical, sensory or mental capabilities or lack of experience and knowledge if they have been given supervision or instruction concerning use of the appliance in a safe way and understand the hazards involved. Children shall not play with the appliance. Cleaning and user maintenance shall not be made by children without supervision.

If the supply cord is damaged, it must be replaced by the manufacturer, its service agent or similarly qualified persons in order to avoid a hazard.

A fire may result if the appliance is not used with care, therefore

- be careful when using the appliance in places where there are combustible materials;
- do not apply to the same place for a long time;
- do not use in presence of an explosive atmosphere;
- be aware that heat may be conducted to combustible materials that are out of sight;
- place the appliance on its stand after use and allow it to cool down before storage;
- do not leave the appliance unattended when it is switched on.

Ensure that the firelighter is properly positioned;

Unplug the firelighter before removal from the fire;

Allow the firelighter to cool before storage;

Do not allow the hot parts of the firelighter to touch the cord or other flammable materials.

WORKING AREA

Keep working area clean and well lit. Untidy and dark areas can lead to accidents.

Do not operate power tools in potentially explosive surroundings, for example, in the presence of inflammable liquids, gases or dust. Power tools create sparks which may ignite the dust or fumes. Keep children and bystanders at a distance when operating a power tool. Distractions can cause you to lose control of it.

ELECTRICAL SAFETY

Always check that the power supply corresponds to the

voltage on the rating plate.

Power tool plugs must match the outlet. Never modify the plug in any way. Do not use adapter plugs with earthed power tools. Unmodified plugs and matching outlets will reduce the risk of an electric shock. Avoid body contact with earthed surfaces such as pipes, radiators, kitchen ranges and refrigerators. There is an increased risk of an electric shock if your body is earthed.

Do not expose power tools to rain or wet conditions. If water gets inside a power tool, it will increase the risk of an electric shock.

Do not damage the cord. Never use the cord for carrying, pulling or unplugging the power tool. Keep the cord away from heat, oil, sharp edges or moving parts. Damaged or entangled cords increase the risk of an electric shock.

When operating a power tool outdoors, use an extension cable suitable for outdoor use.

Using a cord suitable for outdoor use reduces the risk of an electric shock.

If operating a power tool in a damp location is unavoidable, use a power supply protected by a residual current device (RCD). Using an RCD reduces the risk of an electric shock.

PERSONAL SAFETY

Stay alert, watch what you are doing and use common sense when operating a power tool. Do not use a power tool when you are tired or under the influence of drugs, alcohol or medication. A moment of inattention when operating a power tool may result in serious personal

injury.

Use safety equipment. Always wear eye protection. Using safety equipment such as a dust mask, non-skid safety shoes, a hard hat, or hearing protection whenever it is needed will reduce the risk of personal injury.

Avoid accidental starts. Ensure the switch is in the off position before inserting the plug.

Carrying power tools with your finger on the switch or plugging in power tools when the switch is in the on position makes accidents more likely.

Remove any adjusting keys or spanners before turning on the power tool. A spanner or key left attached to a rotating part of the power tool may result in personal injury.

Do not reach out too far. Keep your feet firmly on the ground at all times. This will enable you retain control over the power tool in unexpected situations.

Dress properly. Do not wear loose clothing or jewellery. Keep your hair, clothing and gloves away from the power tool. Loose clothes, jewellery or long hair can become entangled in the moving parts.

If there are devices for connecting dust extraction and collection facilities, please ensure that they are attached and used correctly. Using such devices can reduce dust-related hazards.

POWER TOOL USE AND CARE

Do not expect the power tool to do more than it can. Use the correct power tool for what you want to do. A power tool will achieve better results and be safer if used in the context for which it was designed.

Do not use the power tool if the switch cannot turn it on

and off. A power tool with a broken switch is dangerous and must be repaired.

Disconnect the plug from the power source before making adjustments, changing accessories, or storing power tools. Such preventive safety measures reduce the risk of starting the power tool accidentally.

Store power tools, when not in use, out of the reach of children and do not allow people who are not familiar with the power tool or these instructions to operate it. Power tools are potentially dangerous in the hands of untrained users.

Maintain power tools. Check for misalignment or jammed moving parts, breakages or any other feature that might affect the operation of the power tool. If it is damaged, the power tool must be repaired. Many accidents are caused by using poorly maintained power tools.

Keep cutting tools sharp and clean. Properly maintained cutting tools with sharp cutting edges are less likely to jam and are easier to control.

Use the power tool, accessories and cutting tools, etc., in accordance with these instructions and in the manner intended for the particular type of power tool, taking into account the working conditions and the work which needs to be done. Using a power tool in ways for which it was not intended can lead to potentially hazardous situations.

SERVICE

Your power tool should be serviced by a qualified specialist using only standard spare parts. This will ensure that it meets the required safety standards.

2.2 MACHINE-SPECIFIC SAFETY WARNINGS



When using electric tools, basic safety precautions should always be followed to reduce the risk of fire, electric shock and personal injury. Read all these instructions before attempting to operate this product and save these instructions.

BEFORE USING THE APPLIANCE

Check the following:

Make sure the voltage of the hot air gun corresponds with the power voltage;

Are the mains lead and the mains plug in a good state: strong, without ravel or damages.

Caution is advised when using long extension cables

Do not use the appliance under moist circumstances;

The metal mouthpiece gets hot. Watch out and do not touch the metal mouthpiece;

Prevent damage of the heating element. Do not lock or block the mouth piece or the ventilation openings;

Do not leave the appliance when switched on;

When in operation do not point the device at people or animals

Never look into the hot air nozzle

Do not use this device in rain or damp surroundings, or near explosive or flammable products.

Do not use the device on or near very dry spots to avoid fire.

Always remove the plug from the socket when not using the device, when replacing the nozzles or during maintenance of the device.

Do not point the device at the same place for longer periods of time.

Do not hold the device too close to the surface about to be worked on as the device can overheat.

Pay attention to the direct / indirect work- space as the heat can ignite flammable materials, which are close by but not necessarily in view.

Do not allow the hot parts of the device to touch the cord or other flammable materials.







The device should always be clean, dry and free of grease and oil

Do not use the appliance for purposes other than for which it is intended.

This appliance operates at a temperature of 600 degrees without visible signs of this temperature (no flames), still there is a chance of fire risk.

Watch out for the hot air stream from the mouth piece. This air stream can cause burns.

2.3 SYMBOLS

	Conforms to relevant safety standards
	To reduce the risk of injury, the user must read and understand this manual before using this product.
	Class II product.
	Do not dispose of old appliances with domestic rubbish

3. THE PRODUCT

3.1 DESCRIPTION

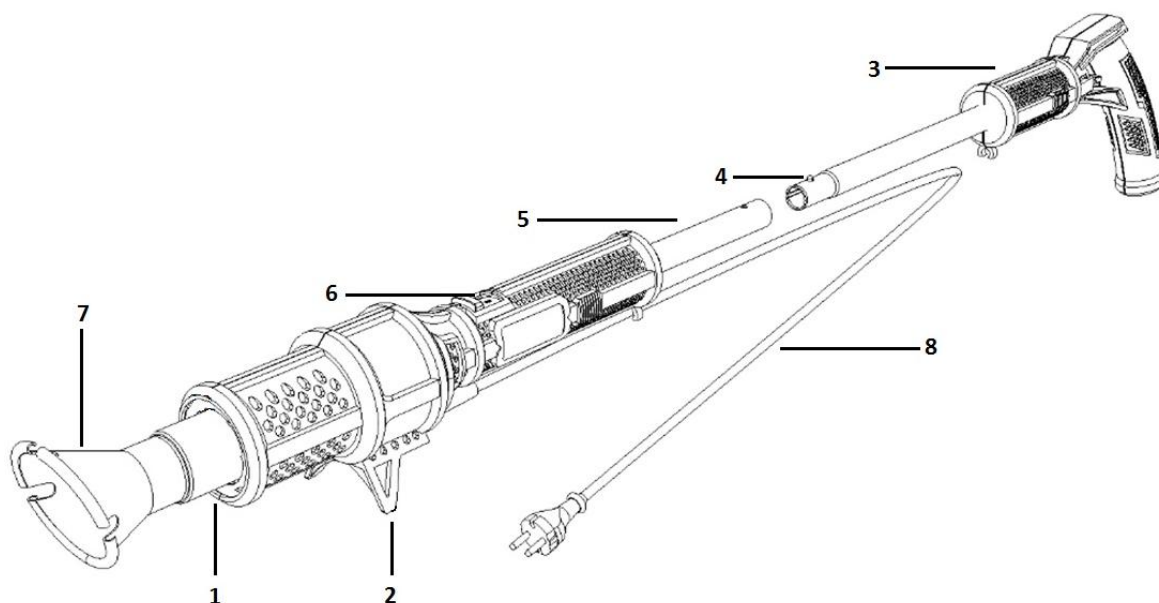

- 1. Hot air nozzle
- 2. Support
- 3. Upper handle
- 4. Lock button
- 5. Lower handle
- 6. On/Off switch
- 7. Weed burning nozzle
- 8. Electric cable



WARNING: Packaging materials are not toys! Children must not play with plastic bags! Danger of suffocation!

Remove all packaging materials.

Remove remaining packing and package inserts (if included).

Check that the package contents are complete.

Check the appliance, the power cord, the power plug and all accessories for transportation damage.

Keep the packing materials as far as possible till the end of the warranty period. Dispose it into your local waste disposal system afterwards.

3.2 PACKAGING CONTENTS

- 1 x Weed burner
- 1 x Nozzle weed burning
- 1 x Manual

If any parts are missing or damaged, please contact your dealer.

3.3 TECHNICAL DETAILS

Model	HWE2000
Voltage	220-240V~
Mains frequency	50-60Hz
Power	2000W
Air temperature	I: 80° C II: 650 ° C
Air stream	550 l/min

4. ASSEMBLY

4.1 WHEN OPERATING THE APPLIANCE

If you are going to use the hot air gun, vapors and gas can be released during a short time. This can be harmful for your health. Asthmatics can suffer hindrance of it;

Before connecting the plug to the mains voltage you have to check if the switch is in position “0” ; Keep the mains lead always away from the mouthpiece of the hot air gun;

Keep children and animals away from the appliance if you are using it.

Keep all parts of the body away from the metal heating head (incl. the nozzle). Do not touch it before it is cooled down. Carry the appliance always and only by the insulated handle, because the burner may come in contact with hidden wiring or its own electrical cable.



WARNING: Always check that the power supply corresponds to the voltage on the rating name plate. Remove the power tool from the packaging. Do not plug it into the electrical grid before assembly.

4.2 ASSEMBLE THE UPPER & LOWER HANDLE

Step 1: Slide the lower handle (5) into the device as far as possible; until it clicks into place (there is only one way to do this).

Step 2: Press the lock button (4) and pull the lower handle in

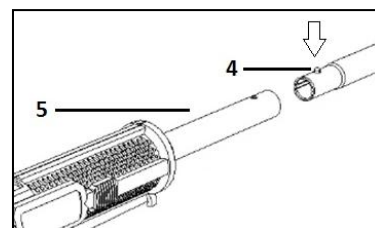

4.3 ASSEMBLE THE NOZZLE

The weed burning nozzle(7) can easily be pushed over the hot air nozzle(1).

The protruding points of the weed burning nozzle(7) must be slid as far as possible into the slots of the hot air nozzle(1). The weed burning nozzle(7) must then be twisted approximately 1cm into the slot.

Attention! The long side of the cap must be on top (this is the side where the switch is located)!

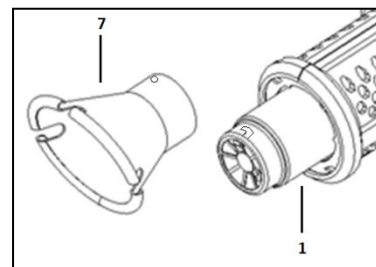

Never touch the nozzles during or immediately after use of the device. The nozzles are very hot!

5. OPERATION

Switching ON/OFF

First check that the cable and plug are not damaged.

Connect the plug to the power supply.

With the on/off- and power switch (6) you can select from two temperature settings. Depending on the application, you can use the following settings:

Setting I—— 80 ° C (venting / cooling)

Setting II—— 650 ° C (weed burning / ignition BBQ)

The volume of air in each setting 500 l/minute



Always use with caution! Do NOT cover the ventilation openings during use as it causes a risk of burns!

Never touch the hot nozzle!

5.1 APPLICATION TIPS

Weed killer

If using the device as a weed killer you must use the extension tube and the handle. Hold the weed killer firmly by holding the end of the extension handle.

Check that all of the relevant safety measures have been implemented.

Ensure the extension handle is firmly fixed onto the device and that the device is turned off.

Lead the electrical cable away from the burner nozzle through the cable clamps on the extension tube and handle.

Install the weed burning nozzle (7) to hot air nozzle (1).

Insert the electric cable (8) into the socket.

Check to ensure the nozzle is not blocked before turning the device on.

Slide the on/off power switch (6) to position II: the device will start to work.

Allow the device about 45 seconds to warm up.

To eliminate weeds, hold the device over the weeds for about 5 seconds. During these 5 seconds the cell structure of the weed is destroyed. As a result, the weed dies within a few days.

It is not necessary to completely burn the weeds, 5 seconds is more than sufficient.

You switch the device off (temporarily) by sliding the power switch back to 0.

The effects are not visible immediately but will take a while before they can be seen. It is more of a long-term effect.

5.2 COOLING AND PERMANENT SWITCHING OFF

Before turning off the device permanently, it must be cooled first. Select temperature setting I for at least one minute. The device can be switched off thereafter.

During cooling down the appliance can be placed on its stand to allow it to cool down before storage. Never leave the appliance unattended!

5.3 STORAGE

Make sure that the device has completely cooled down before storing.

6. CLEANING AND MAINTENANCE



Before performing any work on the equipment, pull the power plug.

Keep the ventilation slots of the machine clean to prevent overheating of the engine.

Regularly clean the machine housing with a soft cloth, preferably after each use.

Keep the ventilation slots free from dust and dirt.

If the dirt does not come off use a soft cloth moistened with soapy water.

Never use solvents such as petrol, alcohol, ammonia water, etc. These solvents may damage the plastic parts.

Make sure no water can reach the inside of the power tool!

7. DISPOSAL



Electrical products should not be discarded with household products. According to the European Directive 2012/19/EU on waste electrical and electronic equipment and its implementation into national law, electrical products used must be collected separately and disposed of at collection points provided for this purpose. Talk with your local authorities or dealer for advice on recycling.

8. DECLARATION OF CONFORMITY



BUILDER SAS

ZI, 32 rue Aristide Bergès – 31270 Cugnaux – France
Tel : +33 (0)5.34.502.502 Fax : +33 (0)5.34.502.503

declares that the machines:
ELECTRIC WEED BURNER
HWE2000
Serial No.: 20210866776-20210867375

is in conformity with the essential requirements and other relevant provisions of the applicable European Directives, based on the application of European harmonized standards. Any unauthorized modification of the apparatus voids this declaration.

European Directives (including, if applicable, their amendments up to the date of signature);

LVD Directive 2014/35/EU

EMC Directive 2014/30/EU

Rohs Directive (EU)2015/863 amending 2011/65/EU

European harmonized standards (including, if applicable, their amendments up to the date of signature);

EN60335-1 : 2012+A11:2014+AC:2014+A13:2017+A1:2019+A14:2019+A2:2019

EN60335-2-45 : 2002+A1:2008+A2:2012

EN 62233:2008

EN55014-1 : 2017

EN55014-2 : 2015

EN61000-3-2 : 2014

EN61000-3-3 : 2013

Cugnaux, 16/11/2021

Philippe MARIE / PDG

9. WARRANTY

HYUNDAI

WARRANTY

The manufacturer guarantees the product against defects in material and workmanship for a period of 2 years from the date of the original purchase. The warranty only applies if the product is for household use. The warranty does not cover breakdowns due to normal wear and tear.

The manufacturer agrees to replace parts identified as defective by the designated distributor. The manufacturer does not accept responsibility for the replacement of the machine, in whole or in part, and/or ensuing damage.

The warranty does not cover breakdowns due to:

- insufficient maintenance.
- abnormal assembly, adjustment or operations of the product.
- parts subject to normal wear and tear.

The warranty does not extend to:

- shipping and packaging costs.
- using the tool for a purpose other than that for which it was designed.
- the use and maintenance of the machine done in a manner not described in the user manual.

Due to our policy of continuous product improvement, we reserve the right to alter or change specifications without notice. Consequently, the product may be different from the information contained therein, but a modification will be undertaken without notice if it is recognized as an improvement of the preceding characteristic.

READ THE MANUAL CAREFULLY BEFORE USING THE MACHINE.

When ordering spare parts, please indicate the part number or code, you can find this in the spare parts list in this manual. Keep the purchase receipt; without it, the warranty is invalid. To help you with your product, we invite you to contact us by phone or via our website:

- **+33 (0)9.70.75.30.30**
- **<https://services.swap-europe.com/contact>**

You must create a "ticket" via the web platform.

- Register or create your account.
- Indicate the reference of the tool.
- Choose the subject of your request.
- Describe your problem.
- Attach these files: invoice or sales receipt, photo of the identification plate (serial number), photo of the part you need (for example: pins on the transformer plug which are broken).



10. PRODUCT FAILURE

WHAT TO DO IF MY MACHINE BREAKS DOWN?

If you bought your product in a store:

- a) Empty the fuel tank if your product has one.
- b) Make sure that your machine is complete with all accessories supplied, and clean! If this is not the case, the repairer will refuse the machine.

Go to the store with the complete machine and with the receipt or invoice.

If you bought your product on a website:

- a) Empty the fuel tank if your product has one..
- b) Make sure that your machine is complete with all accessories supplied, and clean! If this is not the case, the repairer will refuse the machine.
- c) Create a SWAP-Europe service ticket on the site: <https://services.swap-europe.com> When making the request on SWAP-Europe, you must attach the invoice and the photo of the nameplate (serial number).
- d) Contact the repair station to make sure it is available before dropping off the machine.

Go to the repair station with the complete machine packed, accompanied by the purchase invoice and the station support sheet downloadable after the service request is completed on the SWAP-Europe site

For machines with engine failure from manufacturers BRIGGS & STRATTON, HONDA and RATO, please refer to the following instructions.

Repairs will be done by approved engine manufacturers of these manufacturers, see their site:

- <http://www.briggsandstratton.com/eu/fr>
- <http://www.honda-engines-eu.com/fr/service-network-page;jsessionid=5EE8456CF39CD572AA2AEEDFD290CDAE>
- <https://www.rato-europe.com/it/service-network>

Please keep your original packaging to allow for after-sales service returns or pack your machine with a similar cardboard box of the same dimensions.

For any question concerning our after-sales service you can make a request on our website <https://services.swap-europe.com>

Our hotline remains available at +33 (9) 70 75 30 30.



11. WARRANTY EXCLUSIONS

THE WARRANTY DOES NOT COVER:

- Start-up and setting up of the product.
- Damage resulting from normal wear and tear of the product.
- Damage resulting from improper use of the product.
- Damage resulting from assembly or start-up not in accordance with the user manual.
- Breakdowns related to carburetion beyond 90 days and fouling of carburetors.
- Periodic and standard maintenance events.
- Actions of modification and dismantling that directly void the warranty.
- Products whose original authentication marking (brand, serial number) has been degraded, altered or withdrawn.
- Replacement of consumables.
- The use of non-original parts.
- Breakage of parts following impacts or projections.
- Accessories breakdowns.
- Defects and their consequences linked to any external cause.
- Loss of components and loss due to insufficient screwing.
- Cutting components and any damage related to the loosening of parts.
- Overload or overheating.
- Poor power supply quality: faulty voltage, voltage error, etc.
- Damages resulting from the deprivation of enjoyment of the product during the time necessary for repairs and more generally the costs related to the immobilization of the product.
- The costs of a second opinion established by a third party following an estimate by a SWAP-Europe repair station
- The use of a product which would show a defect or a breakage which was not the subject of an immediate report and/or repair with the services of SWAP-Europe.
- Deterioration linked to transport and storage*.
- Launchers beyond 90 days.
- Oil, petrol, grease.
- Damages related to the use of non-compliant fuels or lubricants.

* In accordance with transport legislation, damage related to transport must be declared to carriers within 48 hours maximum after observation by registered letter with acknowledgement of receipt.

This document is a supplement to your notice, a non-exhaustive list.

Attention: all orders must be checked in the presence of the delivery person. In case of refusal by the delivery person, it you must simply refuse the delivery and notify your refusal.

Reminder: the reserves do not exclude the notification by registered letter with acknowledgement within 72 hours.

Information:

Thermal devices must be wintered each season (service available on the SWAP-Europe site). Batteries must be charged before being stored.

HYUNDAI
POWER PRODUCTS

For Inquiries, please contact:

BUILDER SAS
32, Rue Aristide Bergès Z1 31270 Cugnaux, France
Tél.: +33(0)5.34.502.502 Fax : +33(0)5.34.502.503
<http://www.hyundaipower-fr.com/>
Fabriqué en République Populaire de Chine(PRC)